

Technical drawing of a 1/2 inch gas valve assembly. The main view shows a side profile of the valve with dimensions: inlet diameter Ø 50, outlet diameter Ø 34, a 20° arc, a 111mm vertical distance from the base to the outlet, a 162mm vertical distance from the base to the top of the valve body, a 112mm horizontal distance from the base to the outlet, and a maximum 25mm horizontal distance from the base to the outlet. A detail view shows the top of the valve with a 96mm vertical distance from the base to the top of the valve body.

- Keramik-Oberteil 1/2", 180°
- fester Gussauslauf mit Mousseur
- mit Kreuzgriff
- GROHE Long-Life Oberfläche

20 013 AR0 **SINFONIA STANDVENTIL, 1/2"**

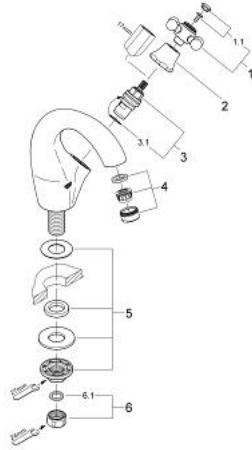

ERSATZTEILE, Januar 2000 – jetzt

1: Kreuzgriff (Bestell-Nr. 45291AR0)

1.1: Markierungsplättchen (Bestell-Nr. 45305000)

2: Abdeckkappe (Bestell-Nr. 00061AV0)

3: Keramik-Oberteil 1/2" (Bestell-Nr. 45346000)

3.1: O-Ring Ø18,2 x Ø1,7 (Bestell-Nr. 0392400M)

4: Mousseur (Bestell-Nr. 13929R00)

4.1: Siebeinsatz, Mousseur M22+M24x1 (Bestell-Nr. 45002000)

5: Gegenverschraubung (Bestell-Nr. 45004000)