

Technical drawing of a vertical pipe assembly. The drawing includes a side view on the left and a front view on the right. The side view shows a pipe with a diameter of 55 and a height of 50. The front view shows a pipe with a diameter of 54 and a height of 61-75. The pipe is connected to a horizontal pipe with a diameter of 34. The horizontal pipe has a height of 11-36 and a distance of 65 from the vertical pipe. The horizontal pipe is bent at a 20° angle. The distance from the horizontal pipe to the top of the vertical pipe is 195. The distance from the horizontal pipe to the bottom of the vertical pipe is 145. The distance from the horizontal pipe to the bottom of the vertical pipe is 89. The distance from the horizontal pipe to the bottom of the vertical pipe is 134. The distance from the horizontal pipe to the bottom of the vertical pipe is 400. The distance from the horizontal pipe to the bottom of the vertical pipe is 600. The distance from the horizontal pipe to the bottom of the vertical pipe is 84. The distance from the horizontal pipe to the bottom of the vertical pipe is 61-75. The distance from the horizontal pipe to the bottom of the vertical pipe is 47. The distance from the horizontal pipe to the bottom of the vertical pipe is 50. The distance from the horizontal pipe to the bottom of the vertical pipe is 28. The distance from the horizontal pipe to the bottom of the vertical pipe is 65. The distance from the horizontal pipe to the bottom of the vertical pipe is 11-36. The distance from the horizontal pipe to the bottom of the vertical pipe is max.25. The distance from the horizontal pipe to the bottom of the vertical pipe is 195. The distance from the horizontal pipe to the bottom of the vertical pipe is 145. The distance from the horizontal pipe to the bottom of the vertical pipe is 89. The distance from the horizontal pipe to the bottom of the vertical pipe is 134. The distance from the horizontal pipe to the bottom of the vertical pipe is 400. The distance from the horizontal pipe to the bottom of the vertical pipe is 600. The distance from the horizontal pipe to the bottom of the vertical pipe is 84. The distance from the horizontal pipe to the bottom of the vertical pipe is 61-75. The distance from the horizontal pipe to the bottom of the vertical pipe is 47. The distance from the horizontal pipe to the bottom of the vertical pipe is 50. The distance from the horizontal pipe to the bottom of the vertical pipe is 28. The distance from the horizontal pipe to the bottom of the vertical pipe is 65. The distance from the horizontal pipe to the bottom of the vertical pipe is 11-36. The distance from the horizontal pipe to the bottom of the vertical pipe is max.25.

- Farbe: chrom
- Einlochmontage
- Hahnlochdurchmesser 35 mm
- Anschlussspannung 24 V
- CE-Zeichen
- Magnetventil
- Durchflussbegrenzer 6 l/min
- 2 flexible Anschlussschläuche
- Schmutzfangsieb
- Rückflussverhinderer
- 2 Eckventile
- ohne Netzteil
- Verdrehsicherung
- Auslauf mit geschlossenem Gehäuse
- GROHE Long-Life Oberfläche

36 144 000 PULSOMAT SURF RADAR-ELEKTRONIK FÜR WASCHTISCH, 1/2" MIT MISCHUNG

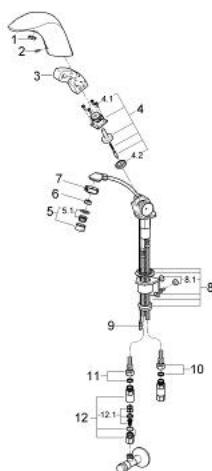

ERSATZTEILE, Januar 1995 – jetzt

- 1: Abdeckkappe (Bestell-Nr. 43411000)
- 2: Schraube (Bestell-Nr. 43093000)
- 3: Elektronik (Bestell-Nr. 43673000)
- 4: Magnetspule (Bestell-Nr. 43635000)
- 4.1: Schrauben (Bestell-Nr. 4308600M)
- 4.2: Membrane (Bestell-Nr. 43737000)
- 5: Mousseur (Bestell-Nr. 13929000)
- 5.1: Siebeinsatz, Mousseur M22+M24x1 (Bestell-Nr. 45002000)
- 6: Durchflussbegrenzer (Bestell-Nr. 43284000)
- 7: Gewinding (Bestell-Nr. 43297000)
- 8: Verdrehsicherung (Bestell-Nr. 43926000)
- 8.1: Druckscheibe (Bestell-Nr. 4307700M)
- 9: Kabel (Bestell-Nr. 43698000)
- 10: Schlauch kalt (Bestell-Nr. 43372000)
- 11: Schlauch warm (Bestell-Nr. 43373000)
- 12: Rückflussverhinderer (Bestell-Nr. 43431000)
- 12.1: Rückflussverhinderer (Bestell-Nr. 42842000)